



Photographic images are property of GUTEX archive

GUTEX Multiplex-top is a rain-tight sarking board with single-ply construction, homogenous cross-section and paraffin impregnation.

Technical Data	Multiplex-top
Joint type	tongue and groove
Thickness (mm)	18/22/28/35
Length x width (mm)	2500 x 750
Actual coverage, length x width (mm)	2476 x 726 (18 mm) 2480 x 728 (22/28 mm) 2480 x 722 (35 mm)
Square metres per board (m ²)	1.875
Weight per board (kg)	6.75/8.25/10.5/13.125
Weight per m ² (kg)	3.6/4.4/5.6/7.0
Boards per pallet	55/45/35/28
Square metres per pallet (m ²)	103.13/84.38/65.63/ 52.5
Weight per pallet (kg)	430
Bulk density (kg/m ³)	200
Vapour diffusion factor (μ)	3
sd-value (m)	0.054/0.066/0.084/ 0.105
Compressive stress/ strength (kPa)	200
Tensile strength perpendicular to board surface (kPa)	30
Air flow resistivity (kPa s/m ³)	100
Short-term water absorption (kg/m ²)	≤ 1.0
Specific heat capacity (J/kgK)	2100
Fire reaction Euro Class as per DIN EN 13501-1	E

European Union	
Nominal thermal conductivity λ_D (W/mK)	0.044
Nominal thermal resistance R_D (m ² K/W)	0.40/0.50/0.60/0.75



Dry manufacturing technique with designation:

WF-EN 13171-T5-WS 1,0-CS(10/Y)100-TR30-MU3-AF100

German disposal category: A2 (treated wood; without non-halogenated organic compounds)

Code number as per AVV:030105; 170201

Applications

- Rain-tight sarking
- In above-rafter constructions as sarking over GUTEX Thermosafe-homogen
- All GUTEX Multiplex-top boards, except those that are 18 mm thick, are suitable for installation directly over rafters.
- 18 mm GUTEX Multiplex-top boards are only suitable for use with above-rafter insulation.

Advantages

- Consistently uniform board dimensions make installation quicker and easier
- Homogeneous, single-ply construction
- Wind tight
- Extra covering or taping of the joints is unnecessary if used with 22, 28 and 35 mm thick boards for pitches greater than 15°. Additional covering and taping of joints is unnecessary for 18 mm boards if the roof pitch exceeds 20°.
- Suitable as temporary roof covering (max. 3 months)
- Adhesive nail tapes or sealants are not required
- Ideal for upgrading the thermal insulation of existing structures
- Reduces thermal bridging
- Superior thermal storage capacity provides outstanding insulation against heat in the summer.
- Significantly improves soundproofing
- Regulates humidity
- Allows vapour diffusion
- Guaranteed by Germany's Association of Roofers
- Wood is a sustainable, recyclable natural resource.
- Made in Germany
- Biologically safe (natureplus® certified)

Composition

Manufactured from untreated Black Forest spruce and fir

- Additives:
 - 4 % polyurethane resin
 - 1.5 % paraffin

Installation

- Store and install this product dry.
- Always install the boards so the side with the marking is exposed on the exterior of the building.
- Max. rafter distance (centre-to-centre):

Thickness in mm	Max. centre-to-centre distance in cm
22	85
28	90
35	100

- Board joints must be butted tightly.
- Avoid walking on areas between the rafters.
- Immediately install battens after installing boards.
- Adhesive nail tapes or sealants are not required.
- Avoid cross joints.



- Do not use damaged boards.
- As a rule, the boards install perpendicular to rafters.
- Stagger butted side joints with the next row's joint being centred no closer than the next rafter.
- All seams and roof joints must be properly sealed via joint tape with prior priming to prevent the ingress of rain, e.g. (available from GUTEX).
- Always install the boards so that their tongues point upwards.
- GUTEX Multiplex-top boards are not designed and made to provide structural support, strength or bear loads.
- Vacuum off the dust in accordance with applicable workplace safety regulations or practices.



Instructions for Specific Roof Pitches

Roof Pitch	Thickness (mm)	
< 15° < 20°	22, 28, 35 18	Suitable moisture barrier or taping (with GUTEX joint tape) of joints required
≥ 15° ≥ 20°	22, 28, 35 18	Not necessary to tape joints provided the pitch is not less than 8° under the recommended pitch specification.

Fixation

Use galvanized or better fasteners

Nails

		GUTEX Multiplex-top 22 / 28 mm			
		Nails per linear metre of batten			
		3.8 x 100 mm nails 30 x 50 mm batten cross section			
		Snow load (kN/m ²)			
		0.75	1.0	1.5	2.5
Weight of roofing (kN/m ²)	0.35	3/3	3/3	3/3	4/4
	0.60	3/3	3/3	3/4	4/5
	0.95	3/4	3/4	4/5	5/6

		GUTEX Multiplex-top 35 mm			
		Nails per linear metre of batten			
		5.0 x 140 mm nails (Power nails 3.8 x 130 mm) 40 x 60 mm batten cross section			
		Snow load (kN/m ²)			
		0.75	1.0	1.5	2.5
Weight of roofing (kN/m ²)	0.35	3(3)	3(3)	3(4)	3(6)
	0.60	3(4)	3(4)	3(5)	4(7)
	0.95	3(5)	3(6)	4(7)	5(8)

Cramps

		GUTEX Multiplex-top 22 mm			
		Cramps per linear metre of cross batten			
		2.0 x 90 mm cramps (12 mm width) 30 x 50 mm batten cross section			
		Snow load (kN/m ²)			
		0.75	1.0	1.5	2.5
Weight of roofing (kN/m ²)	0.35	4	5	6	8
	0.60	5	6	7	9
	0.95	7	8	9	11

		GUTEX Multiplex-top 28 mm			
		Cramps per linear metre of cross batten			
		2.0 x 110 mm cramps (12 mm width) 30 x 50 mm batten cross section			
		Snow load (kN/m ²)			
		0.75	1.0	1.5	2.5
Weight of roofing (kN/m ²)	0.35	5	5	7	9
	0.60	7	7	9	11
	0.95	9	10	11	14

		GUTEX Multiplex-top 35 mm			
		Cramps per linear metre of cross batten			
		2.0 x 120 mm cramps (12 mm width) 30 x 50 mm batten cross section			
		Snow load (kN/m ²)			
		0.75	1.0	1.5	2.5
Weight of roofing (kN/m ²)	0.35	7	8	10	14
	0.60	9	10	12	16
	0.95	13	14	16	20

Detail Drawings

Roof Interruptions

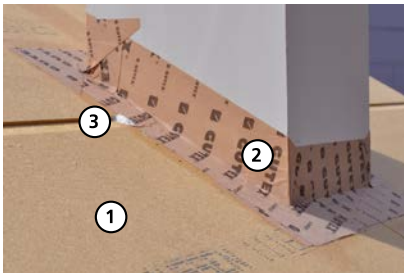

- ① GUTEX Multiplex-top
- ② GUTEX Joint Sealing Kit
- ③ GUTEX Sealing Caulking

Ridges

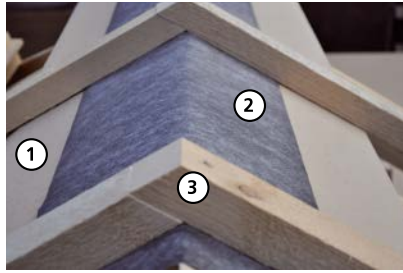

- ① GUTEX Multiplex-top
- ② Vapour permeable roofing felt
- ③ Cross battens

Gable Ends

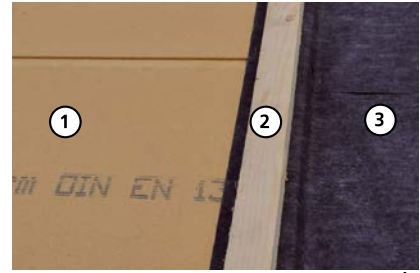

- ① GUTEX Multiplex-top
- ② Cross battens
- ③ Vapour permeable roofing felt

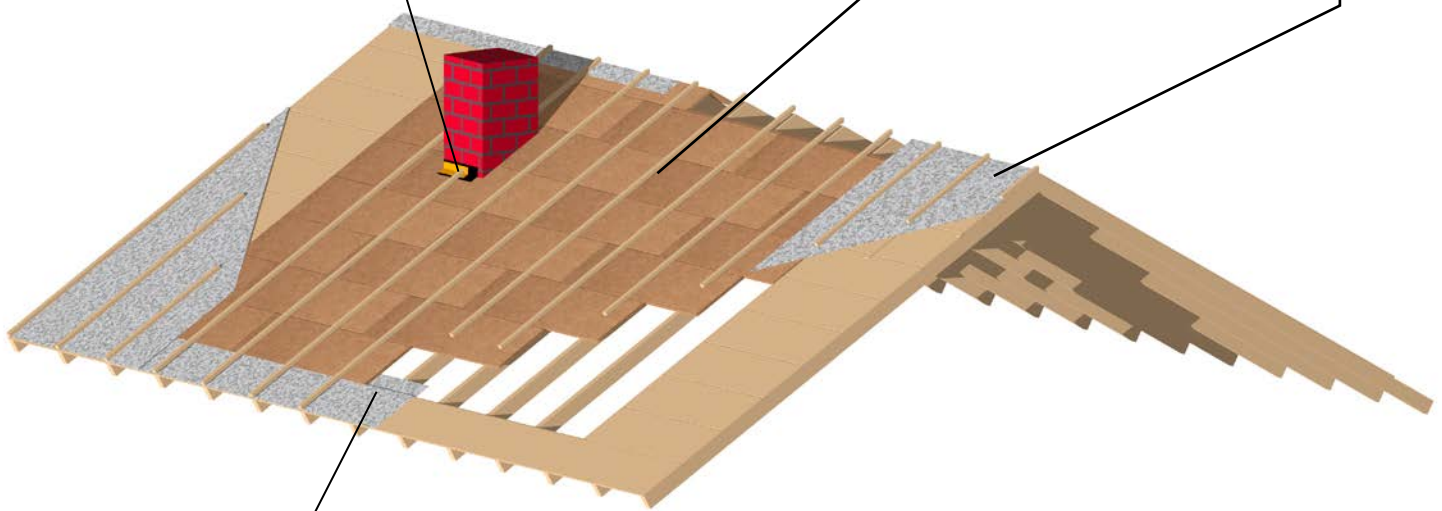

Eaves Variation 1

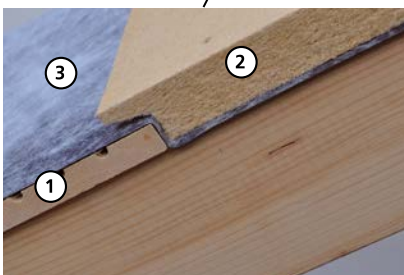

- ① Sheathing of exterior overhang
- ② GUTEX Multiplex-top
- ③ Vapour permeable roofing felt

Eaves Variation 2



- ① GUTEX Multiplex-top
- ② Vapour permeable roofing felt
- ③ Cross battens

Valleys



- ① GUTEX Multiplex-top
- ② GUTEX Joint Sealing Kit
- ③ GUTEX Caulking

All rights reserved. Henselmann GmbH + Co KG is not liable for any damage resulting from error or misprinting. The technical data provided herein is subject to change. Although all of the information was current at the time of its publication, the publication of superseding

information renders the old information invalid.

The suitability of this product for applications not specified in this data sheet is not guaranteed. Warranty and liability claims are subject to the terms of Gutex's General Terms of Business.

Ecological Building Systems

For stockist information and full technical support for your project, please contact Ecological Building Systems or visit www.EcologicalBuildingSystems.com

