

Installation Guide Attic Hatch



Time of installation: Watch humidity at construction side!
Only install attic stairs when standard climate has been established.

Always install attic hatch without stairs.

Annually inspect in order to ensure that all screws and nuts, except for those at the rotation points of the levers, are tightened securely. Make sure to lubricate all joints / rotation points with oil once a year.

1

Set-up levers: After tightening loosen by 1/2 turn (rotation point).

EinbauVideo



Futterkasten
Hebel
Ringöse

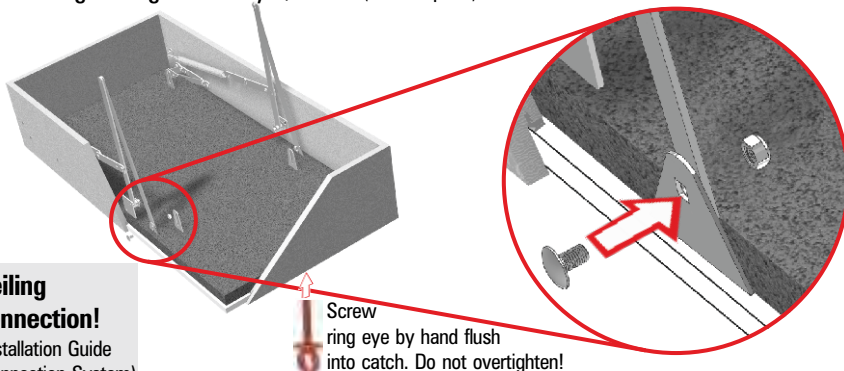

After lever set-up: Spring check!
Spring hook must hang correctly in the eyelet:



Ceiling connection!
(Installation Guide Connection System)



Before hanging the attic hatch, glue the sealing tape into the ceiling opening.

2

Strap two roof battens, hinge-in attic hatch and align it horizontally with 4 wooden wedges (spirit level).

EinbauVideo



Futterkasten
Ausrichten
Höhe

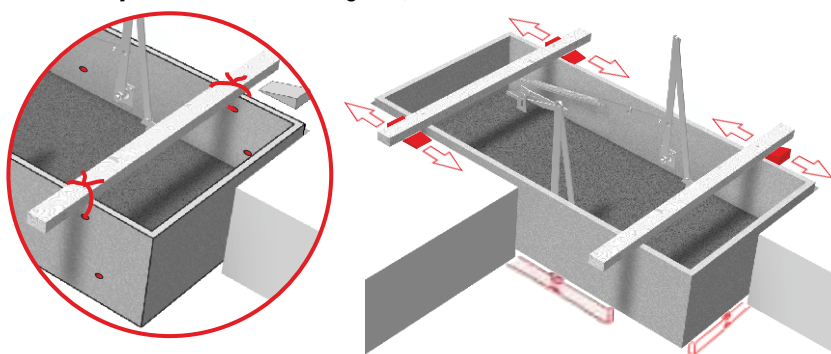

Casing frame flush with ceiling, door protrudes 2 mm!

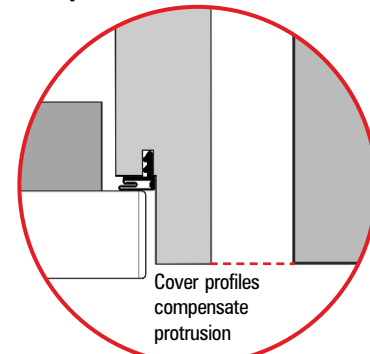

3

Underlay at pre-drilled holes and screw in adjusting screws (6x). **Align to right angle** and **center** attic hatch in the middle of the ceiling opening. For concrete ceiling, use 8-mm dowels.

(Remeasure diagonals, balance distance between hatch frame and door along the longitudinal sides).

EinbauVideo



Futterkasten
Ausrichten
rechtwinklig

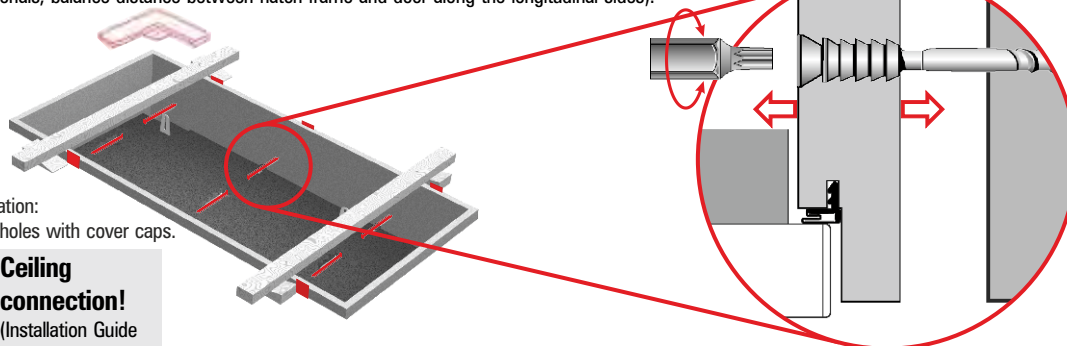

At end of installation:
Close mounting holes with cover caps.



Ceiling connection!
(Installation Guide Connection System)



Push insulation braid into the gap.
Glue sealing tape on frame bar.

4

After completion of any other work on the ceiling: Mount cover profiles: Interlock. Test. Uncover adhesive tape. Press on firmly. Fix. (see Installation Guide cover profiles)

Installation of stairs:
Please turn page over!



User safety: Guardrail!
Installation possible at any later point.

weilhöfer
TREPPEN AUS WÜRZBURG

Installation Guide Stairs

! Correct height adjustment: The installation of the floor must be completed entirely.

3-section: GutHolz / AluDrei / StahlBlau

DIN EN 14975 **DIN 3193**

All attic stairs are manufactured in accordance with DIN-EN and are overload method tested for a load of 150 kg (AluDrei for 200 kg).

1 Fasten stairs with screws **within supports**. Install handrail (Installation Guide Handrail).



Fasten screw
in supports.

GutHolz: Hang in stairs. If the floor-to-ceiling height is incorrect, cut to length (Guide Floor-to-ceiling Height)
Fit ladder feet covers (Installation Guide Ladder feet covers)
Then:

2 For **height adjustment**, adjust stringers in the lower supports until **stair sections are in alignment**. Only then tighten all screws.

! **Incorrect!**

Stair sections are not in alignment:

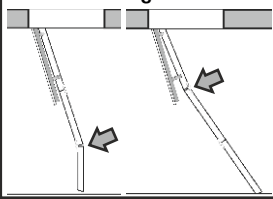

STEEP

= maximum floor-to-ceiling height

FLAT

= minimum floor-to-ceiling height

Concertina: Liliput

In case of Liliput with comfort operation pay attention: Installation guide Liliput comfort operation

1 Loosen the two upper screw nuts of the stair.

2 Fasten stair with screws **within supports**.

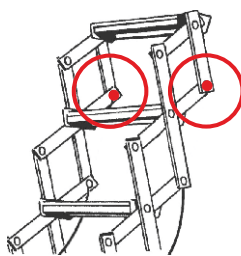

Install handrail telescope
(Installation Guide Liliput Handrail Telescope)

Do not loosen round stoppers!
Must remain fixed for a firm stand.

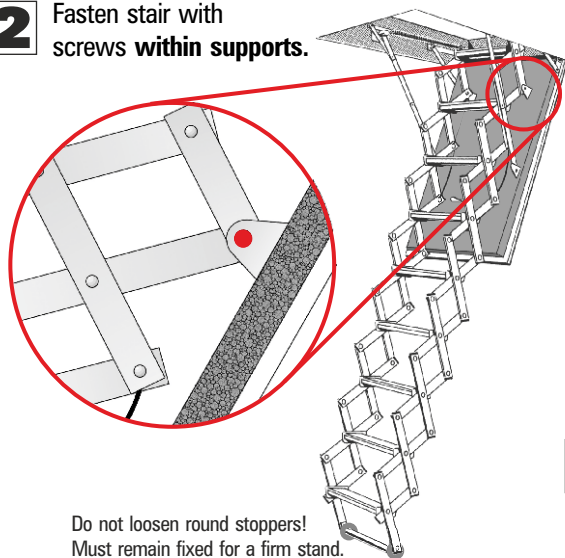

3 Align stairs parallel to the fully opened door. Check secure stand.

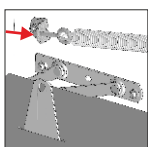
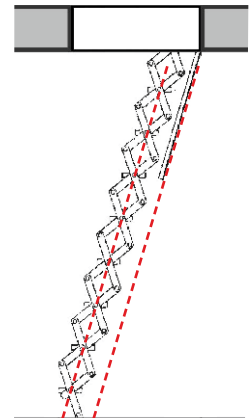

When installation is completed, **check tight closing of the hatch door** and fine tune the factory setted spring tension if necessary (nut at ringscrew).
Springs are under tension!
Therefore only adjust from above with hatch door closed.

Note cladding: thickness maximum 20 mm, use longer ring eye screw; distributed load maximum 10 kg/m²; gap width between hatch door and frame minimum 3.5 mm. Hatch door > 1 m² use stronger springs.

weilhöfer
TREPPEN AUS WÜRZBURG

Setting the correct floor-to-ceiling height

GutHolz
Attic Stairs
AluDrei
Attic Stairs
StahlBlau
Attic Stairs



Adjust stringers in the lower supports until **stair sections are in alignment**.
Only then tighten all screws.

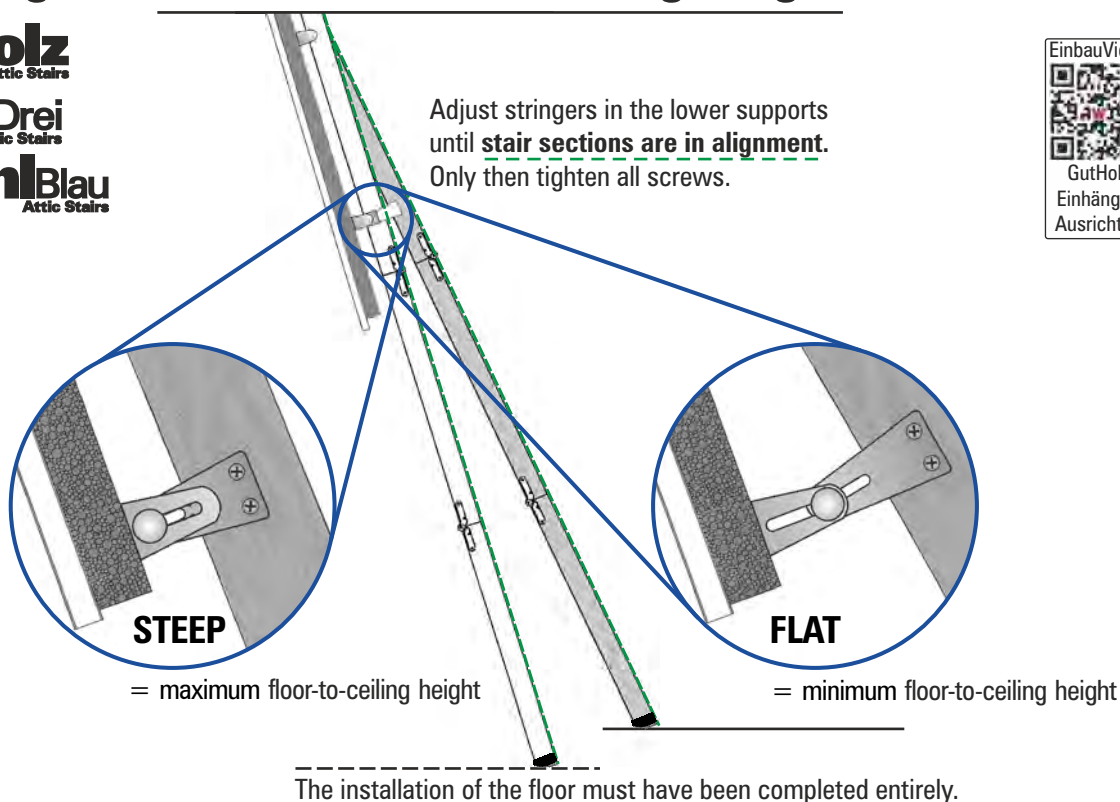

! If height adjustment fails to get stringers in alignment:

A Stairs too long:
Our recommendation:
Make a new order with
correct floor-to-ceiling height.

A

B Stairs too short:
Make a new order with
correct floor-to-ceiling height.

B

Or:

Cutting to the right length

1 Measuring and marking:
Select medium height adjustment. Fold-in bottom stair section: upper and middle stair sections must be flush. Measure at the forward stringer edge. Mark on lower stringers (**A - 45 mm!**).

Distance between floor and 1st step:

At least half a
step space $\geq I/2$

DIN EN
14975

Step
space I

At least half a
step space $\geq I/2$

2 Cut to length:
Saw lower stringers
at a right angle
at distance **A - 45 mm**.

3 After fitting the ladder feet covers:
Fine adjustments to correct height
(see above)

weilhöfer
TREPPEN AUS WÜRZBURG

Installation Guide **LiliPut** with comfort operation



- 1 Securing the stairs:** Loosen both top nuts of the stairs.
Screw-fix the stairs within the supports. (Installation Guide Attic Stairs LiliPut stairs)

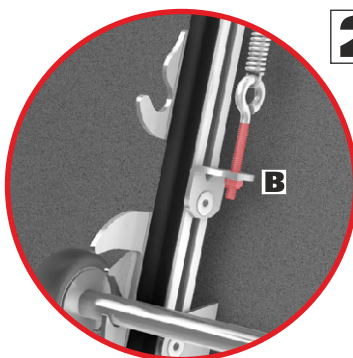
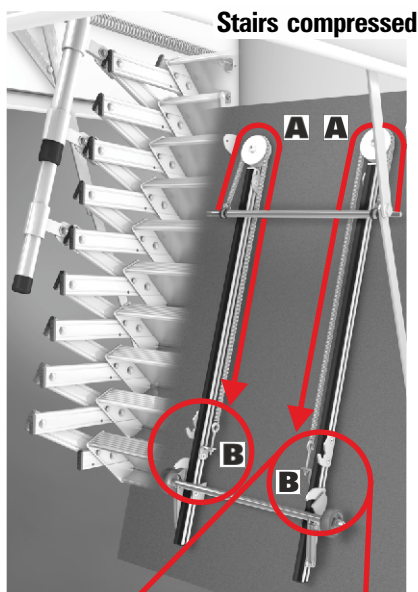

- 2 Mounting the springs:**
Compress the stairs until the foot rod lies safely in the arrester hook.
(See user information below)

- A** Guide the springs to the **top around the deflection rollers** to the inside and **under the fixing rod** on the attic hatch door downwards.
B Screw-fix the eyelets at the spring end in brackets (inside sliding rails) **on both sides in the same position**.

- 3 Extend stairs** until the stairs stands firmly on the floor.

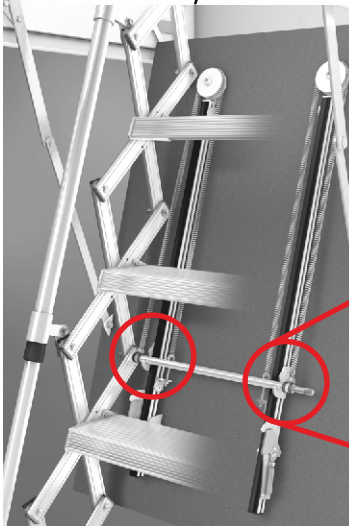

- 4 Set the upper fixing hooks:**
Loosen the hooks and re-position them at the fixing rod: In the **unloaded condition**, screw-fix the fixing hooks on both sides, resting at the fixing rod.

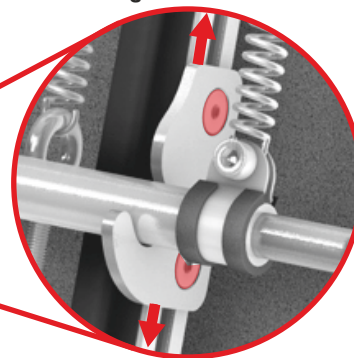

3
screws

- 5 Setting the lower arrester hooks:**
Loosen 3 screws and re-position the arrester hooks as close as possible at the upper fixing hooks. Screw-fix **both sides** at the same height. Prevent step contact.

weilhöfer
TREPPEN AUS WÜRZBURG

User information concertina stairs with comfort operation

Extension: Use tension rod to push stairs upwards **out of arrester hooks** and let down.

Setting up: Pull downwards until stairs stands firmly on the floor and the fixing rod lies in the fixing hooks.

Compress: Push together until the foot rod at the rocker slides into the arrester hooks.

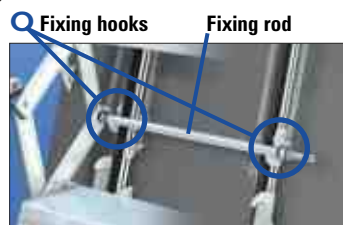
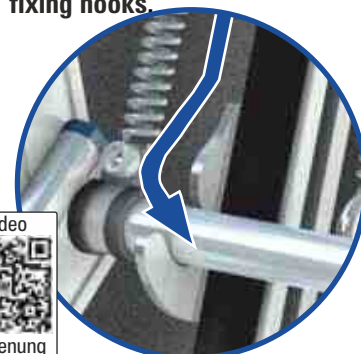

Operating the stairs:



Installation Guide Connection System

Always apply sealing tape to ceiling opening prior to installation of attic hatch!
Watch ceiling construction! (see below)

1 Glue sealing tape in place:

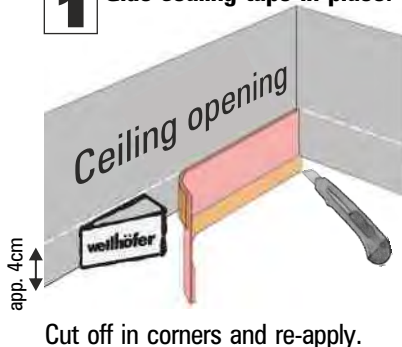

2 Install attic hatch (Installation Guide Attic Stairs / Access Hatch)

3 Push in insulation braid:

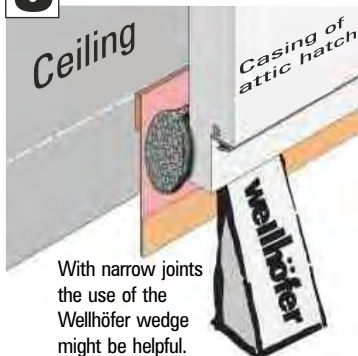

Cut off in corners and re-apply. For close connection upset joints in the corners.



For attic stairs with fire protection FS:
 Push in hardly flammable fire protection braid instead of insulating braid!
 (Installation Guide Attic Stairs FS)

4 Close the gap:

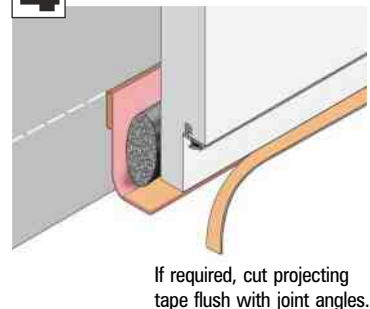

Glue sealing tape to lining bar all over.

5 Install cover profiles (Installation Guide Cover Profiles)

Full effect is gained only if the ceiling connection system has been implemented as described above.

wellhöfer
 TREPPEN AUS WÜRZBURG



Correct air-tight connection:

Glue Wellhöfer sealing tape tightly and securely onto the on-site air-tight barrier!
Watch ceiling construction / thermal bridges / fire protection regulations and where necessary fill additional insulation into gap on-site.



Concrete ceiling

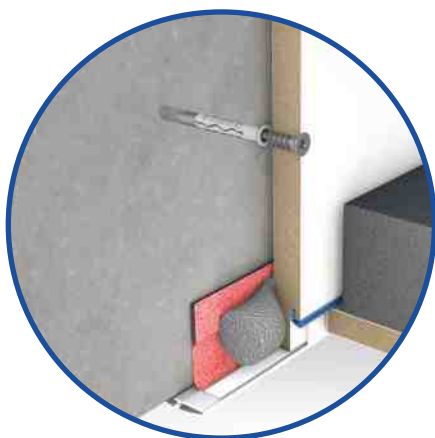

Suspended ceiling

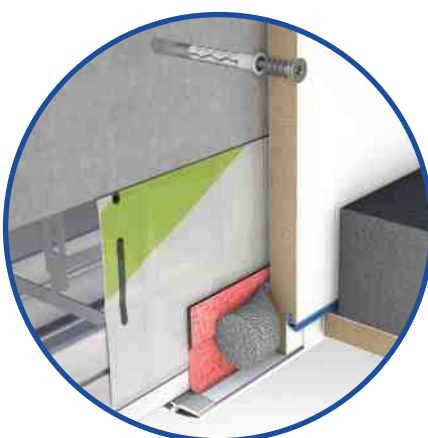

Wodden beam ceiling with counter battens



wellhöfer
 TREPPEN AUS WÜRZBURG

Installation Guide PH-Connection System

-  Apply sealing tape prior to installation of attic hatch!
Apply sealing tape to airtightness layer on site.



1 Certified design of the connection gap



1 Glue sealing tape in place:

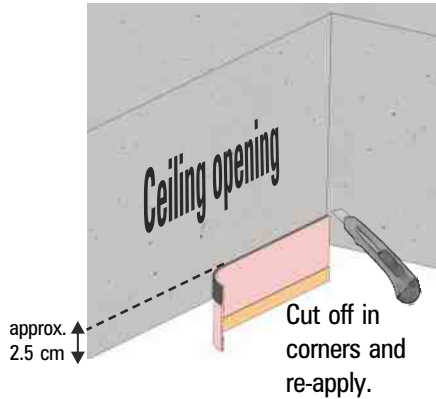

2 Install attic hatch

(see Installation Guide Attic Hatch)

3 Push in insulation braid:

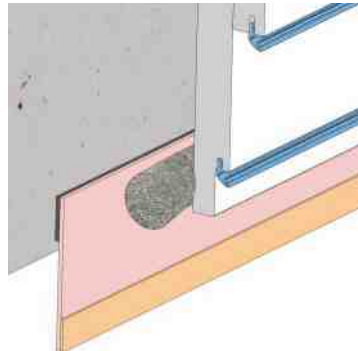

Cut off in corners and re-apply.
To achieve full effect, upset joints in the corners.

4 Close the gap:

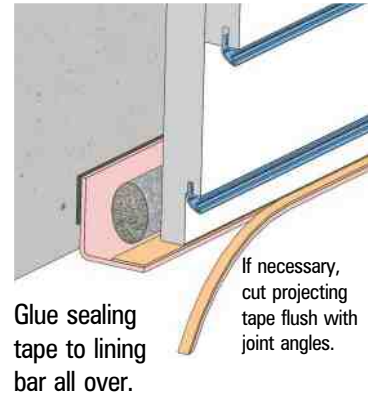

5 Apply cover profiles:

(see Installation Guide Cover Profiles)



2 Certified design of the connection gap



1 Close installation boreholes:

Apply cover caps to the inside of the attic hatch.

2 Insulate the gap completely

Use funnel to gradually add the pour-in insulation right up to the top around the entire circumference.
(a gap of approx. 2 cm should be left on top)

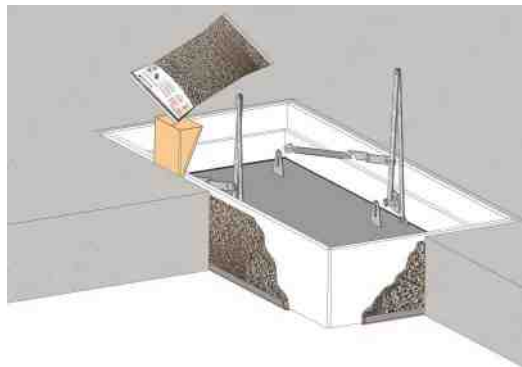

3 Certified design of the connection gap



1 Close the top gap:

Push in insulation braid flush around the entire circumference.

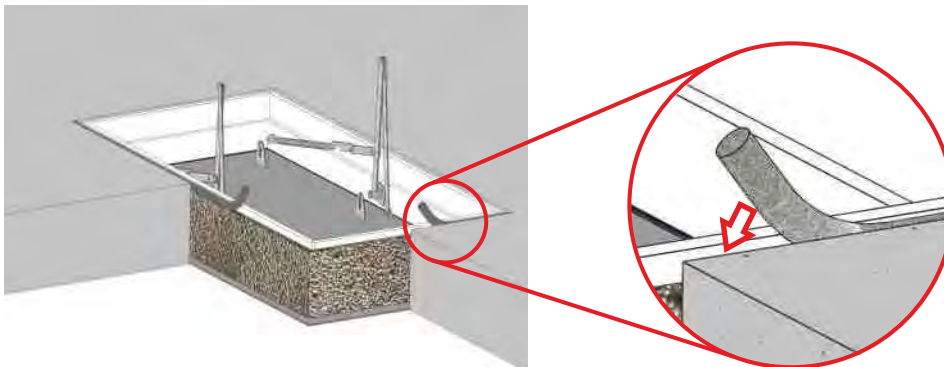

Only when the PH-Connection System is executed as described does it correspond to the passive house certification.

weilhöfer
TREPPEN AUS WÜRZBURG

Installation Guide cover profiles

Unpack and mount cover profiles only after completion of any other work on the ceiling!

- 1 Interlock frame:**
Interlock cover profiles to form a frame with the help of corner joints.

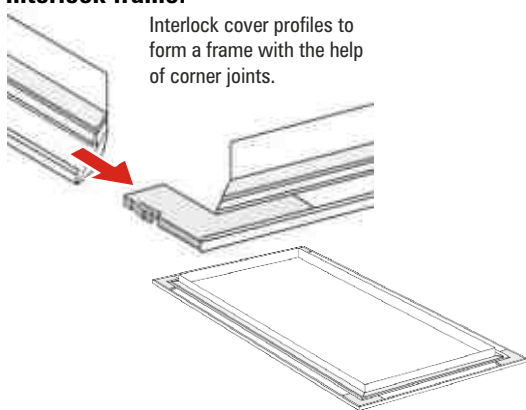

- 2 Attach frame by way of trial.**

- 4 Mount cover profiles:**
Keep attic hatch closed and press frame from below onto clean lining bar and press firmly.

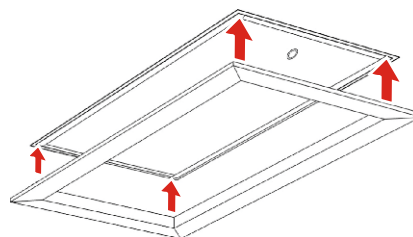

- 5 Secure cover profiles**
Screw in enclosed screws flush with bit:
- opening side 1x
- both longitudinal sides 2x
- distance to bottom edge 1.5 cm
- distance to corner 20 cm

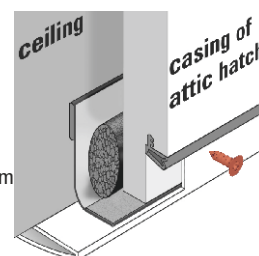

- 3 Uncover adhesive tape:**

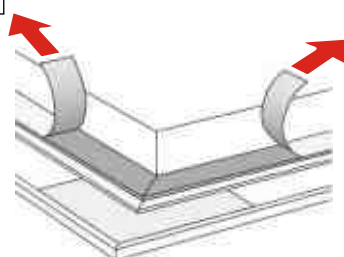

- 6 Remove protective foil from cover profiles bottom.**



244-915_E523

weilhöfer
TREPPEN AUS WÜRZBURG

Installation Guide Guardrail



- 1** Mount **posts**:
Place height limiters on side panels.
Glue and screw posts in place.
- 2** Mount **triangular supports** on exit side:
Glue to the top edge of the casing and flush with the posts. Screw tight.
- 3** Screw tight **battens**:
Always start with one long side.
Reference:
2 post holes = outer grooves
1 post hole = middle groove
Pre-drill battens with \varnothing 3mm drill.
- 4** When all battens are screwed tight, cut length if necessary.

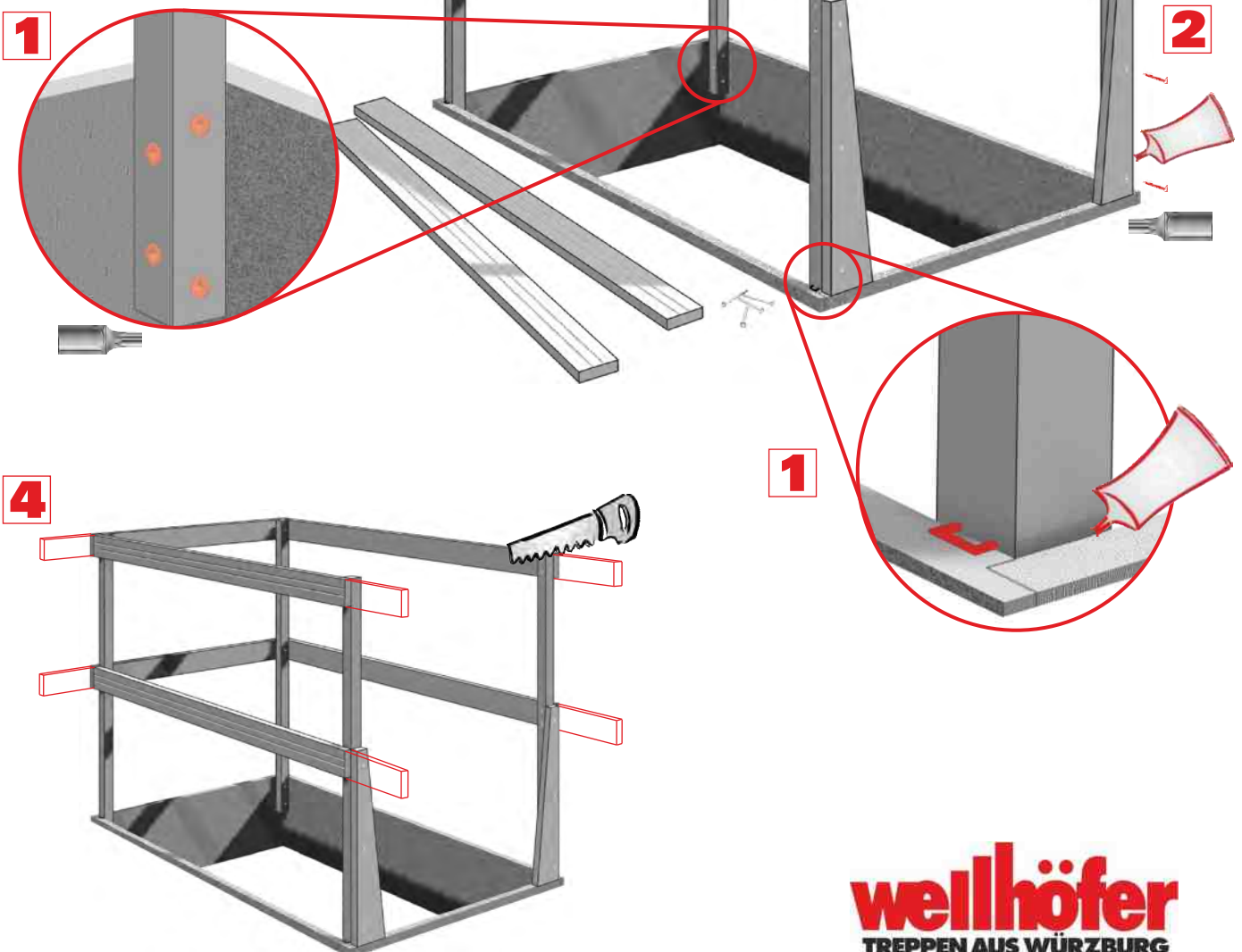

wellhöfer
TREPPEN AUS WÜRZBURG

Installation Guide Handrail for Gut**Holz** / **Stahl**Blau

Do not put any load on stairs during installation of the handrail!

Install handrail together with stairs. 

(Installation Guide Attic Stairs / Stair part)

Handrail can be used right or left.

For high stairs with left side spring, only right-side handrail possible.

- 1** Fix handrail outside the supports (stair part inside). Use screws of the stair fastening.

- 2** Mount handrail as parallel as possible to the stringers: Select suitable of the 3 punched holes. Adjust stairs to floor-to-ceiling height. (Installation Guide Attic Stairs / Stair part) Tighten screws.

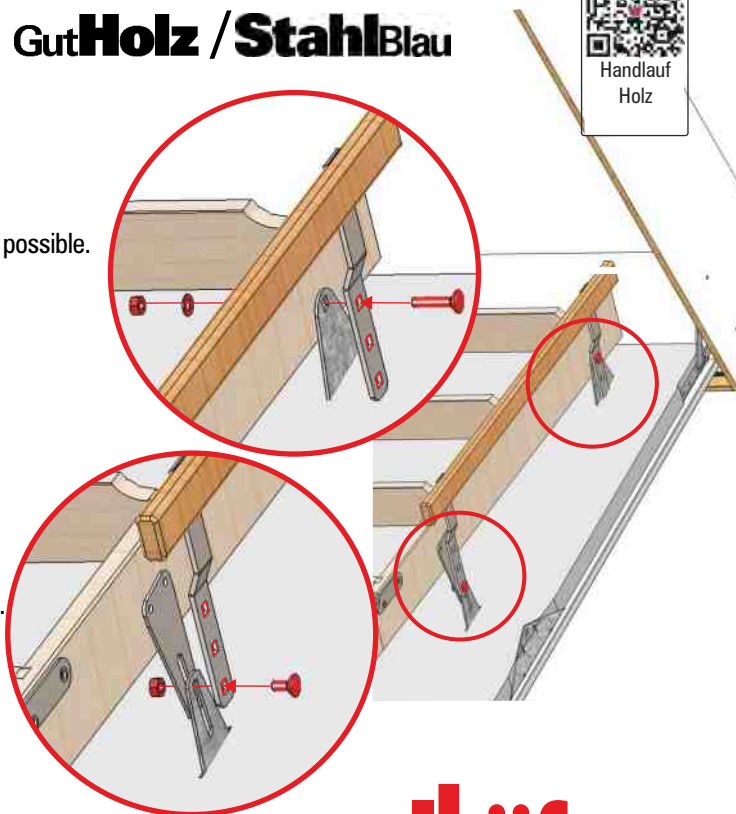

 Watch for correct height adjustment of the stairs!
(Installation Guide Attic Stairs / Stair part)

weilhöfer
TREPPEN AUS WÜRZBURG

Installation Guide **Alu**Drei -Handrail

Do not put any load on stairs during installation of the handrail!

- 1** Mounting supports in wooden handrail  Watch arrangement of supports for LEFT/RIGHT use
For high stairs with left side spring, only right-side handrail possible.

Handrail
LEFT

Handrail
RIGHT

At top always long support

At bottom always short support

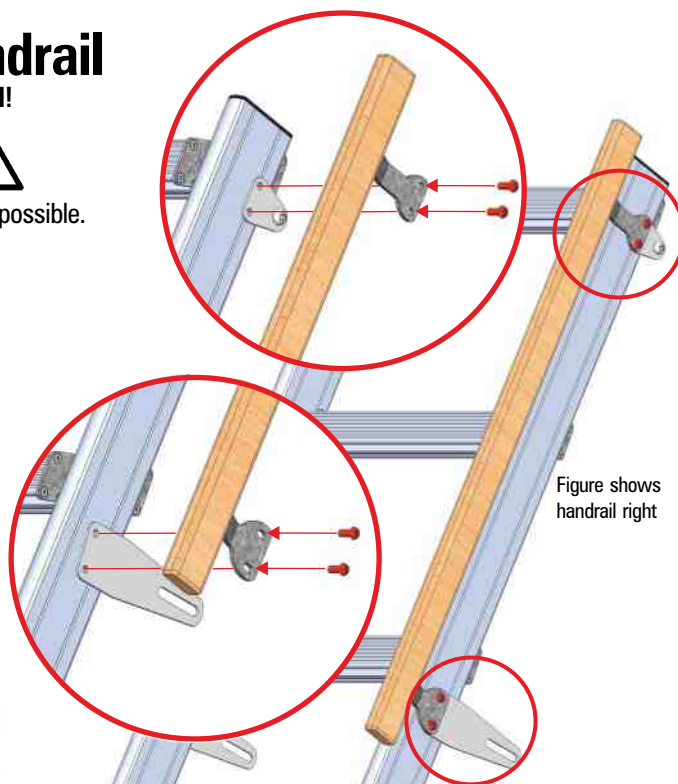
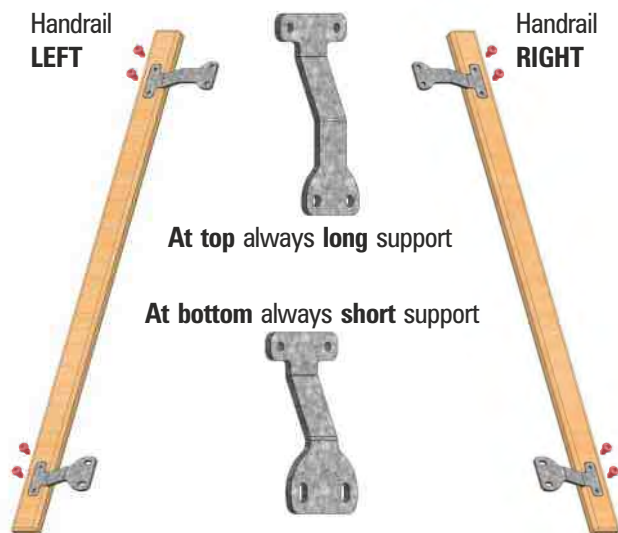

- 2** Screw handrail to stairs

- 3** Install stairs
(Installation Guide Attic Stairs / Stair part)

weilhöfer
TREPPEN AUS WÜRZBURG



Installation Guide Handrail Telescope for Liliput



Observe mounting direction!

Alignment of handrail depends on ceiling opening length, ceiling thickness / casing height and additional equipment!

Standard installation direction:

Handrail with **thick end upwards**

(Black handrail support on the uppermost bolt)

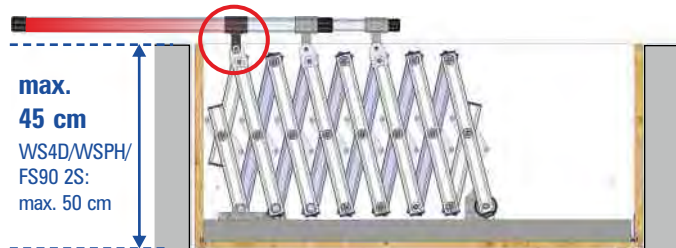

Mount handrail on all supports of the concertina stairs:

Position handrail and insert bolts. Fix the bolts on the back by sliding on the safety clips.



Short bolts for metal supports.
Long bolt for black handrail support!



For **higher ceiling thickness / casing height / flat roof exit**: Reverse installation direction.

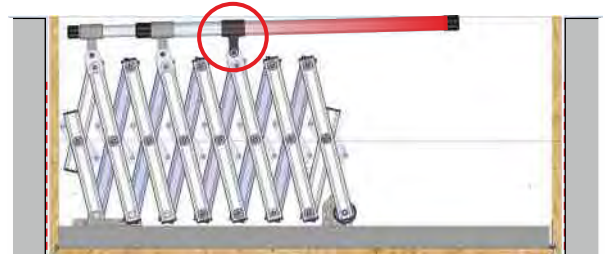

Handrail with **thick end downwards**

(Black handrail support on the lowest bolt)

Minimum ceiling opening length required:

min. 113 cm

WSPH: min. 120 cm

FS90 2S: min. 117 cm

For retrofitting: Place handrail supports

The handrail can be used on **both sides** (right or left).

Place supports on the bolts 1 / 3 / 5 (see above).

For floor-to-ceiling heights ≥ 374 cm, attach to bolts 2 / 4 / 6.

1 Remove the retaining ring with pincers.
(Retaining rings are broken after removal)

2 Pull out the bolt and push in the sleeve.
Important: Thin washer between stringers must remain there.

3 Push on the handrail supports.
Fasten with enclosed M8 bolts and lock nuts.

4 Fix handrail inside the supports.
(see above)

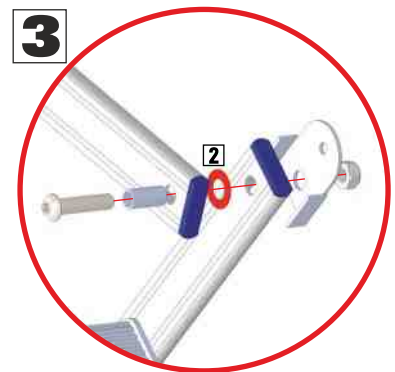
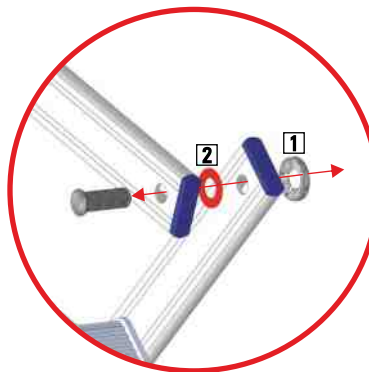

3

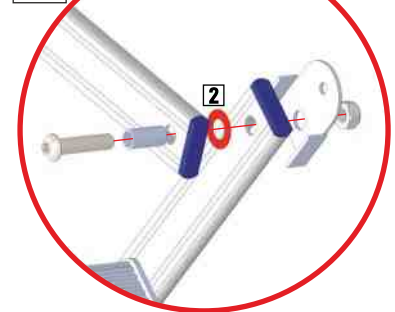

weilhöfer
TREPPEN AUS WÜRZBURG

For over 20 years, Ecological Building Systems has been at the forefront of environmental and sustainable building products supplying a range of innovative airtightness solutions and natural insulations backed up with expert technical support.

As product suppliers in the UK and Ireland, we're happy to assist you with your projects and have expert technical and sales advice on hand.



Call us

Great Britain +44 (0)1228 711511

Ireland +353 46 9432104



Email us

info@ecologicalbuildingsystems.com



Find us

Great Britain Ecological Building Systems UK Ltd.,
Cardewlees, Carlisle, Cumbria, CA5 6LF,
United Kingdom

Ireland Ecological Building Systems Ltd.,
Main Street, Athboy. Co. Meath, C15 Y678,
Republic of Ireland