

Installation instructions

DUPLEX

Installation steps

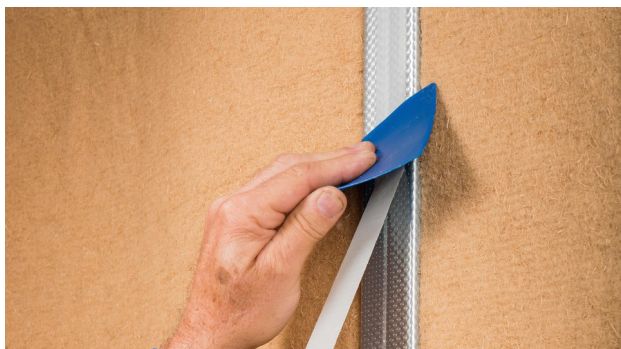

1. Fastening to stud wall frame members

Fastening of membranes to metal frame members on stud wall and ceiling structures. Roll out DUPLEX and rub firmly onto the subsurface using PRESSFIX.



2. Cut the liner with a utility knife

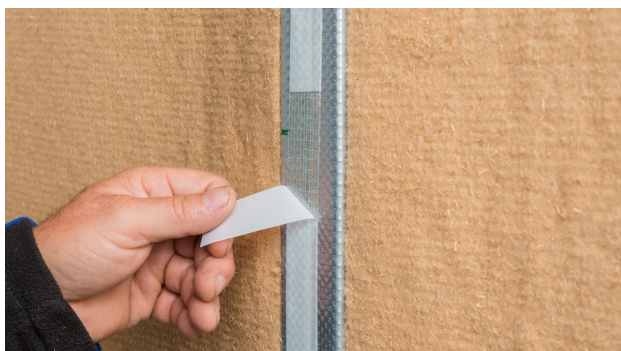

3. Remove the liner



4. Roll out the membrane

... and press it onto the adhesive tape. Stick the membrane in place, ensuring that there are no folds or tension.



5. Rub using the PRESSFIX application tool to secure

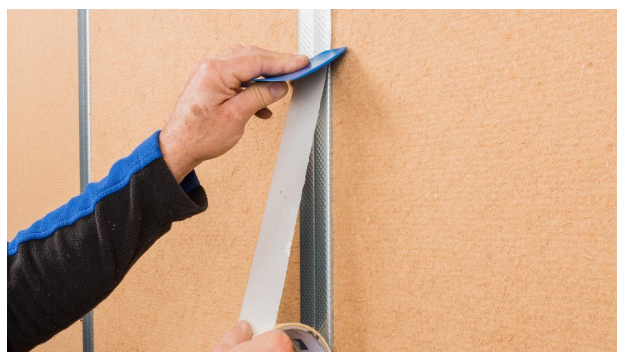

6. DUPLEX is also available in a width of 4 cm (1 5/8")

Substrates

Clean subsurfaces before applying tape. Adhesion is not possible on frozen surfaces. There must be no water-repellent substances (e.g. grease or silicone) on surfaces where adhesives are to be applied. Subsurfaces must be sufficiently dry and stable.

Permanent adhesion is achieved on all pro clima interior and exterior membranes, on other vapour control and airtight membranes (e.g. those made of PE, PA, PP and aluminium) and on other underlay and breather (WRB) membranes (e.g. those made of PP and PET). Adhesive bonds are possible with planed and painted wood, hard plastics and metal (e.g. pipes, windows etc.) and hard wood-based panels (chipboard, OSB and plywood panels).

The best results in terms of reliability are achieved on high-quality subsurfaces. It is your responsibility to check the suitability of the subsurface; adhesion tests may be necessary in certain cases. Pre-treatment with TESCON PRIMER is recommended in the case of subsurfaces that have insufficient stability.

General conditions

Stuck joints must not be subjected to tensile forces. Rub the adhesive tapes firmly to secure the adhesive bonds. Ensure that there is sufficient resistance pressure. Windproof, airtight or rainproof sealing can only be achieved on vapour control or underlay/facade membranes that have been installed without folds or creases. Ventilate continuously and systematically to prevent build-up of excessive humidity; use a dryer if necessary.

The information provided here is based on practical experience and the current state of knowledge. We reserve the right to make changes to the recommended designs and processing or to make alterations due to technical developments and associated improvements in the quality of our products. We would be happy to inform you of the current technical state of the art at the time you use our products.

Further information about installation and design details is available in the pro clima planning documentation. If you have any questions, please contact [pro clima Technical Support](<https://proclima.com/service/technical-support>).

MOLL

bauökologische Produkte GmbH

Rheintalstraße 35 - 43

D-68723 Schwetzingen

Fon: +49 (0) 62 02 - 27 82.0

eMail: info@proclima.de

For over 20 years, Ecological Building Systems has been at the forefront of environmental and sustainable building products supplying a range of innovative airtightness solutions and natural insulations backed up with expert technical support.

As product suppliers in the UK and Ireland, we're happy to assist you with your projects and have expert technical and sales advice on hand.



Call us

Great Britain +44 (0)1228 711511

Ireland +353 46 9432104



Email us

info@ecologicalbuildingsystems.com



Find us

Great Britain Ecological Building Systems UK Ltd.,
Cardewlees, Carlisle, Cumbria, CA5 6LF,
United Kingdom

Ireland Ecological Building Systems Ltd.,
Main Street, Athboy. Co. Meath, C15 Y678,
Republic of Ireland