

Installation instructions

SOLITEX® FRONTA® WA

Installation steps



1. Install the membrane

Roll out the membrane and use galvanised staples that are at least 10 mm ($\frac{3}{8}$ ") wide by 8 mm ($\frac{5}{16}$ ") long to fasten the membrane in the overlap area at intervals of 10-15 cm (4"-6") in a manner that protects against moisture entry. Install the membrane leaving an additional 4 cm ($1\frac{1}{2}$ ") overlap at adjacent building structures so that a windtight bond can be applied here subsequently.



2. Apply double-sided adhesive tape

Clean the subsurface (dry and free of dust, silicone and grease), stick DUPLEX double-sided adhesive tape to the lower third of the subsequent overlap in a manner that protects against moisture. Rub the tape firmly using the PRESSFIX to secure the adhesive bond. Ensure that there is sufficient resistance pressure.



3. Overlap the membranes

Overlap the membranes for at least 10 cm (4") so that they are watertight. The printed markings on the membrane serve as a guide here.



4. Stick the overlaps

Gradually remove the release film from DUPLEX and stick the overlapping membrane, ensuring that there are no folds or tension. Rub the tape firmly using the PRESSFIX to secure the adhesive bond. Ensure that there is sufficient resistance pressure.



5a. Alternatively: Taping over the overlaps with TESCON VANA

Tape TESCON VANA adhesive tape centrally to the overlap and stick it down bit by bit so that it is load and wrinkle free.



5b. Alternatively: Tape over the overlaps with TESCON VANA

Rub the tape firmly using the PRESSFIX to secure the adhesive bond. Ensure that there is sufficient resistance pressure.



6a. Sealing to rough or mineral surfaces (e.g. floorboard)

Clean the surface. Apply a bead of ORCON F adhesive sealant – at least 5 mm ($\frac{3}{16}$ ") thick (more in the case of very rough surfaces).



6b. Sealing to rough or mineral surfaces (e.g. floorboard)

Apply the membrane, leaving slack to allow for expansion, and do not press the adhesive completely flat to allow for relative motion between components.

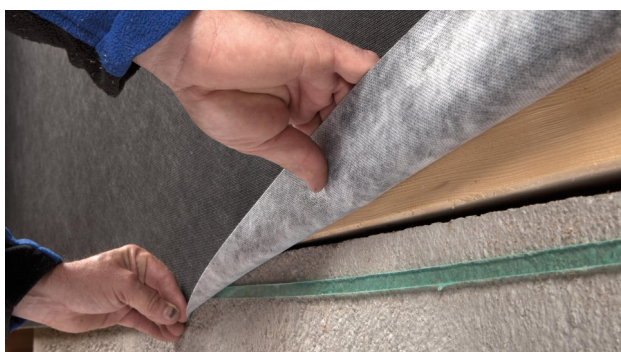

7. Alternatively: Sticking to rough or mineral surfaces (e.g. floorboard) with ORCON MULTIBOND

Stick line of adhesive to the subsurface, remove release film and stick the membrane in place, leaving slack to allow for expansion.



8a. Sealing around windows

Install membranes continuously over window openings and attach them all around the window using a stapler. Then cut open the opening using a utility knife.

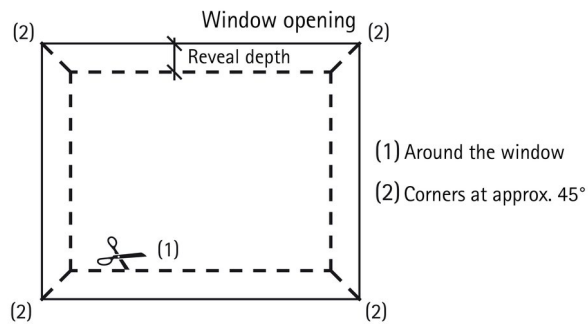

8b. Sealing around windows

In the case of recessed windows, cut into the membrane as shown in the sketch and guide into the reveal as far as the frame.

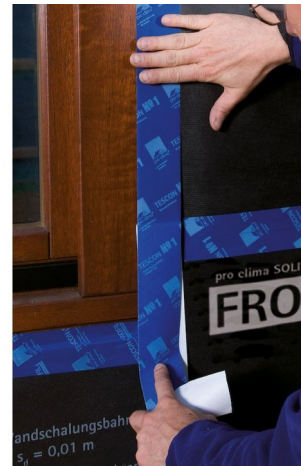
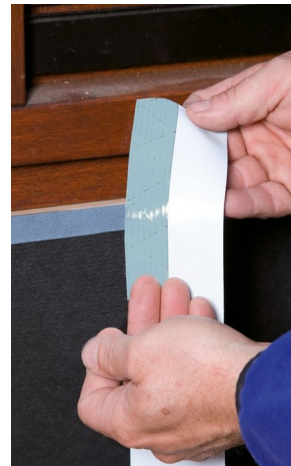

9. Sealing around windows

Tape the membrane to the window frame using TESCON PROTECT to ensure a windtight seal. Thanks to the split release paper it is possible to stick the tape first to the membrane and then, subsequently, to the window. Alternatively use TESCON VANA or TESCON INVIS.



10. Sealing cable and pipe penetrations

Place KAFLEX or ROFLEX sealing grommets over the cable or pipe and stick to the membrane. The cable sleeves are self-adhesive. Tape the pipe grommets to the membrane with TESCON VANA or TESCON INVIS.



11. Sealing angular penetrations

Slide the TESCON PROTECT pre-folded corner sealing tape into the corner on the release film and stick the first independent adhesive strip. Then remove the release film and stick the second independent adhesive strip.



12. Installation of decking

Horizontal or vertical installation of decking.

SOLITEX FRONTA WA: Only for closed decking.

SOLITEX FRONTA QUATTRO: For gap widths up to max. 35 mm (1 3/8").

SOLITEX FRONTA QUATTRO FB: Flame-resistant.

SOLITEX FRONTA PENTA: For gap widths up to max. 50 mm (2").

General conditions

SOLITEX FRONTA WA membranes are to be installed horizontally in a taut manner with no sagging.

The membrane must not be secured in areas where water collectively drains off.

The membrane can be used behind closed facades with at least 20 mm (1") of rear ventilation.

Additional measures (e.g. covering with tarpaulins) should be taken during the construction phase in the case of buildings that are lived in or buildings that are to be given particular protection. Covering with tarpaulins should also be considered if construction work is to be interrupted for a longer period.

The information provided here is based on practical experience and the current state of knowledge. We reserve the right to make changes to the recommended designs and processing or to make alterations due to technical developments and associated improvements in the quality of our products. We would be happy to inform you of the current technical state of the art at the time you use our products.

Further information about installation and design details is available in the pro clima planning documentation. If you have any questions, please contact [pro clima Technical Support](<https://proclima.com/service/technical-support>).

MOLL

bauökologische Produkte GmbH

Rheintalstraße 35 - 43

D-68723 Schwetzingen

Fon: +49 (0) 62 02 - 27 82.0

eMail: info@proclima.de

For over 20 years, Ecological Building Systems has been at the forefront of environmental and sustainable building products supplying a range of innovative airtightness solutions and natural insulations backed up with expert technical support.

As product suppliers in the UK and Ireland, we're happy to assist you with your projects and have expert technical and sales advice on hand.



Call us

Great Britain +44 (0)1228 711511

Ireland +353 46 9432104



Email us

info@ecologicalbuildingsystems.com



Find us

Great Britain Ecological Building Systems UK Ltd.,
Cardewlees, Carlisle, Cumbria, CA5 6LF,
United Kingdom

Ireland Ecological Building Systems Ltd.,
Main Street, Athboy. Co. Meath, C15 Y678,
Republic of Ireland